

KOMO®
Product certificate
K61720-2



| | | | |
|-------------|------------|----------|------------|
| Issued | 2025-10-09 | Replaces | K61720/01 |
| Valid until | Indefinite | Dated | 2011-02-16 |
| Page | 1 of 3 | | |

Steel for reinforcement of concrete B500B: welded fabric and bars

Van Merksteijn Steel - Netherlands B.V.

STATEMENT BY KIWA

This product certificate is based on Guideline/BRL 0501 "Steel for the reinforcement of concrete" (Betonstaal)" dated 01 September 2010 inclusive amendment sheet dated 12 December 2018, issued according to the Kiwa-Regulation for Certification.

The quality system and the product characteristics of this product are checked periodically. Based on this, **Kiwa declares that** there is legitimate confidence that:

Upon delivery, the product supplied by the certificate holder meets the requirements:

- Of the technical specifications laid down in this product certificate,
- The product requirements laid down in the Guideline/BRL 0501.

Provided the product is accompanied by the KOMO® quality mark in the manner set out in this product certificate.

Wim van Loon
Managing Director Netherlands

This product certificate is also included on the KOMO foundation websites: www.komo.nl and www.komo-online.nl. Users of this product certificate is advised to check whether it is still valid. For this purpose consult the website of Kiwa: www.kiwa.nl.

Kiwa Nederland B.V.
Sir Winston Churchilllaan 273
Postbus 70
2280 AB RIJSWIJK
The Netherlands
Tel. 088 998 44 00
info@kiwa.com
www.kiwa.nl

Certificate holder
Van Merksteijn Steel - Netherlands B.V.
Bedrijvenpark Twente 237
7602 KJ ALMELO
Tel. 0546 58 82 00
info@van-merksteijn.nl
www.van-merksteijn.com



Assessed is:

- Quality system
- Product
- Periodic control

CERTIFICATE

473200612

Steel for the reinforcement of concrete B500B: welded fabrics and bars

1 TECHNICAL SPECIFICATION

This product certificate relates to the product characteristics of Steel for the reinforcement of concrete, B500B (welded fabric and bars).

The products are intended for use in concrete structures.

The following products are covered by this product certificate:

| | |
|--------------------|------------------------------|
| Classification | : B500B |
| Production method | : Hot rolled /cold stretched |
| Nominal size | : 6, 8, 10, 12, 14 and 16 mm |
| Delivery condition | : welded fabrics and bars |

2 QUALITY MARK AND INDICATIONS PLACED ON THE PRODUCTS

The products are marked with a label with upon it at least on a clear and indelible way:

- The KOMO[®] indication or the KOMO[®] quality mark followed by the certificate number. The official KOMO quality mark is shown and executed as follows:



- The classification B500B
- BRL 0501
- Diameter
- The rolling mark
- Production code (heat number / cast number / coil number) or production date
- Factory brand or factory name

At least one label per bundle of bars / package of welded fabrics is required.

Steel for the reinforcement of concrete is marked on the following way:
 On two rib rows by means of thickened ribs, with the code (2-21), see figure 1.
 On the other two rows of ribs, by use of a single thickened rib, see figure 1.

On two rib rows by thicken ribs with the code (1-21), see figure 2.
 On the other two rows of ribs, by use of a single thickened rib, see figure 2

Position of the rolling mark: at intervals of ± 0.50 m. The position of the transverse ribs may also be reversed.

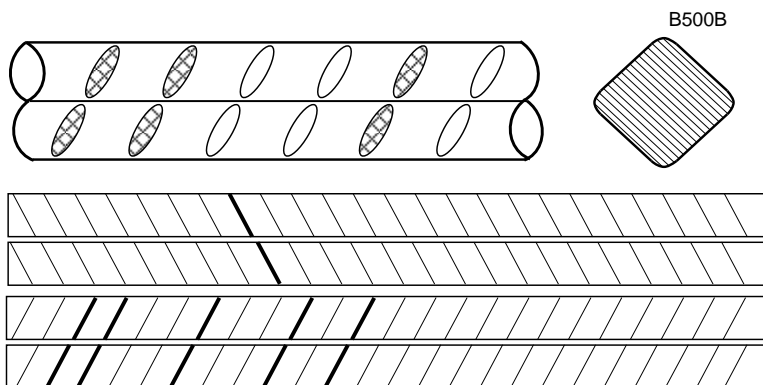

(2-21) Figure 1

Steel for the reinforcement of concrete B500B: welded fabrics and bars

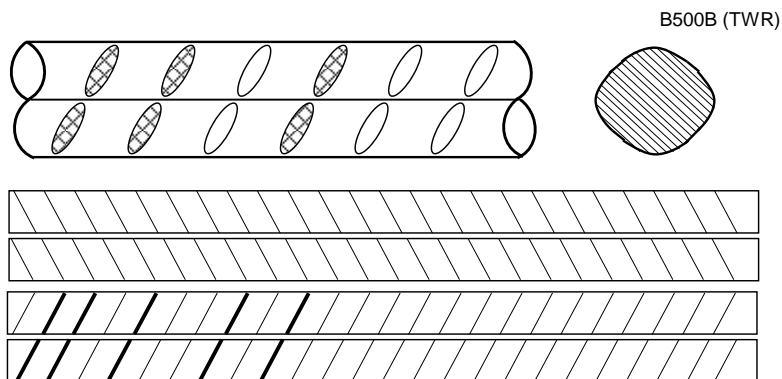

(1-21) Figure 2

3 PRODUCT CHARACTERISTICS

The product meets the product characteristics as laid down in Guideline/BRL 0501.

4 TIPS FOR THE USER

Check on delivery of the products listed under the “technical specification” whether:

- The product(s) and material(s) ordered are delivered in accordance with the agreement you made;
- The brand and the method of marking is correct;
- No defects or damage is visible (for example, resulting from the transportation).

If on the basis of the foregoing you decide to proceed to rejection, please contact

- Van Merksteijn Steel - Netherlands B.V.

And if necessary,

- Kiwa Nederland B.V.

Consult NEN-EN 13670 for the correct method of storage, transport and processing.

Consult the website www.kiwa.nl to check whether this product certificate is still valid.

LIST OF DOCUMENTS

- NEN 6008 : Betonstaal
 NEN-EN 13670 : Het vervaardigen van betonconstructies

* For the actual version of the standards see the latest version of the BRL 0501 or latest amendment sheet.